



SEA FORCE ONE



LONDON

www.seaforceoneyacht.com



SEA FORCE ONE

SEA FORCE ONE, with her extraordinary design and decor, has set what can be considered a new milestone in the yachting world.

A mysterious black hull is topped with an elegant and almost military-looking grey superstructure. A mixture of curves and rigid lines surround a spectacular state-of-the-art LED lighting and music system into which guests can immerse themselves, feeling almost in another world.

The owner's suite and the four guest cabins share the overall themes of the boat - luxury, comfort, elegance and absolute entertainment - although each is quite different in decor, providing residents with different experiences as they pass from one area to another. Ultra-soft fabrics, leather floors and Barrisol ceilings make her an amazing entertaining venue at night, while during the day both the beach and the impressive sun-deck make it hard to bring yourself to leave SEA FORCE ONE.



UPPER DECK SALOON



SEA FORCE ONE

A fully fledged home cinema and a disco bar make the on-board entertaining experience a step up from almost any other yacht of her size.

SEA FORCE ONE has been developed to conform to the sought-after RINA's Green Star code and she also is one of the first yachts worldwide to be awarded RINA's Secure Yacht coding relating to the standard of personal safety and security for crew and guests.

Her impressive hull design allows her to cruise at over 15 knots, reaching a max speed of 18 knots, while her zero speed stabilizers provide a comfortable stay for her guests.

The balconies and skylights connect her unique and generous interior spaces to the outside world, making SEA FORCE ONE the ultimate example of modern luxury.



UPPER DECK SALOON





OWNER'S SUITE



OWNER'S BATHROOM / STEAMROOM



OWNER'S OFFICE





VIP CABIN



GUEST CABIN







SEA FORCE ONE

LOBBY, GYM, GALLEY, BRIDGE



GYM



GALLEY



BRIDGE



SEA FORCE ONE

LAYOUT



LOWER DECK

- LEFT VIP CABIN – EARTH
- RIGHT VIP CABIN – TREASURE
- BEACH
- LEFT GUEST CABIN – CUBIST
- RIGHT GUEST CABIN – JETLAG
- GARAGE

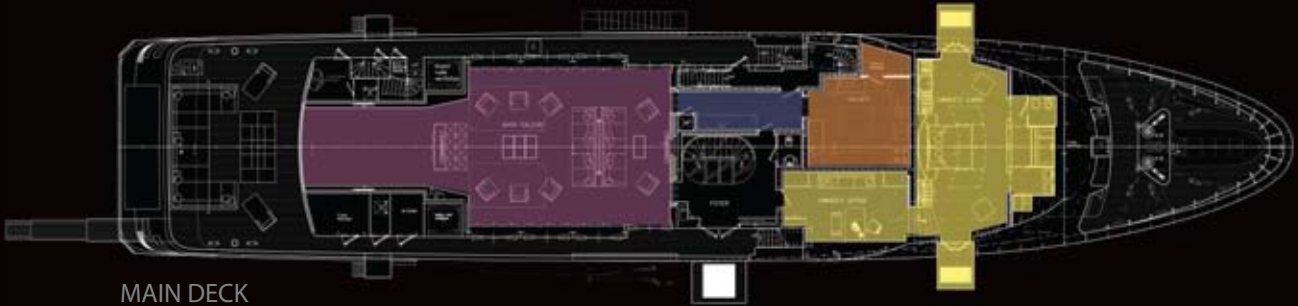

MAIN DECK

- MAIN DECK SALOON
- OWNER'S SUITE
- GALLEY
- PANTRY



UPPER DECK

- UPPER DECK SALOON
- PANTRY
- GYM
- BRIDGE

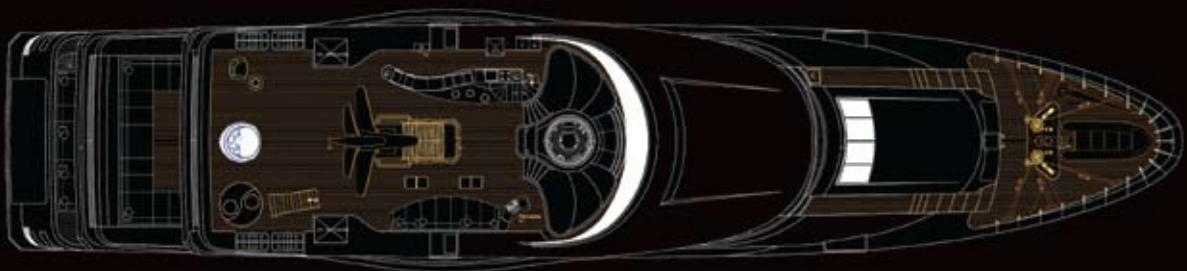

SUN DECK

SPECIFICATIONS

Builder:	Admiral / AMY
Design:	Luca Dini
Year Built:	2008
Interior Design:	Owner
LOA:	176.50 ft (53.80 m)
Beam:	34.45 ft (10.50 m)
Maximum Draft:	9.52 ft (2.90 m)
Max Engines:	2 x CATERPILLAR 3516B
Cruising Speed:	15 knots
Max Speed:	18 knots
Range:	5,000 nm
Flag:	British
Water:	6,602 US gallons (25,000 l)
Engineering:	AMY Engineering
Material:	Steel Hull and Aluminum Superstructure ABS Malta Cross A1, AMS, ENV.SAFE, CONF Y, GREEN STAR, SECURE MEGAYACHT



ACCOMMODATION

Guest Cabins:	5
Guests Sleeping:	10 (12)
Guests Cruising:	12

ENTERTAINMENT

Extensive DVD/CD library
10 ft (3 m) home cinema in main saloon
8.7 ft (2.5 m) home cinema in owner's suite
iPod capability throughout the yacht
Fully fledged video and music DJ console
Internet access

TENDERS & TOYS

Pascoe Shuttle 6.2
Sea-Doo Speedster
Sea-Doo Jet-ski
Sea Bob Cayago VX2
(2) 1-person Sea Kayak
Fishing Equipment
Snorkelling Equipment
Water Skis
Water Toys